

CITY OF NAPOLEON GENERAL PERMIT APPLICATION

THIS APPLICATION IS FOR RESIDENTIAL CONSTRUCTION INCLUDING BUILDING, ELECTRICAL,
PLUMBING, MECHANICAL & REMODELING

P-16-0077
Building

DATE 3/30/15 JOB LOCATION 1012 WEST WASHINGTON ST.
 OWNER BLESCHKE, LINDA TELEPHONE # 419-594-6468
 OWNER ADDRESS 1012 WEST WASHINGTON ST
 CONTRACTOR GREENWORKS REMODELING CELL PHONE # 419-474-6330
 DESCRIPTION OF WORK TO BE PERFORMED Front Porch

ESTIMATED COMPLETION DATE APR. 30. 2016 ESTIMATED COST 2450.00

Affected Floor Area (AFA): In existing structures, it is the area affected by the improvement, i.e. a new wall dividing a room (the AFA would be only the room and not all the rooms).

DESCRIPTION	FEE	TOTAL COST
BUILDING:		
<i>Decks</i>	\$25.00	\$ <u>25.00</u>
<i>Addition & Alterations</i> Square foot in (AFA) _____ x \$0.05 = \$ _____ + \$25.00 = \$ _____		
Garage and Shed over 200 SF (Detached)	\$25.00	\$ _____
Siding and/or Roofing	\$25.00	\$ _____
Windows/Doors	\$25.00	\$ _____
ELECTRICAL:		
<i>Electrical</i> Circuits in (AFA) _____ x \$3.00/Circuit = \$ _____ + \$25.00 = \$ _____		
Electrical Service Upgrade	\$25.00	\$ _____
MECHANICAL:		
Water Heater	\$25.00	\$ _____
Furnace and/or AC Replacement	\$25.00	\$ _____
PLUMBING:		
<i>Plumbing</i> Traps in (AFA) _____ x \$3.00/Trap = \$ _____ + \$25.00 = \$ _____		
TOTAL plus Ohio Board of Building Standards Fee 1%		\$ <u>25</u>

TOTAL FEE: \$ 25.25

I FULLY UNDERSTAND THAT NO EXCAVATION, CONSTRUCTION OR STRUCTURAL ALTERATION, ELECTRICAL OR MECHANICAL INSTALLATION OR ALTERATION OF ANY BUILDING STRUCTURE, SIGN, OR PART THEREOF AND NO USE OF THE ABOVE SHALL BE UNDERTAKEN OR PERFORMED UNTIL THE PERMIT APPLIED FOR HEREIN HAS BEEN APPROVED AND ISSUED BY THE CITY OF NAPOLEON BUILDING/ZONING DEPARTMENT.

I hereby certify that I am the Owner of the named property, or that the proposed work is authorized by the Owner of record and that I have been authorized by the Owner to make this application as his/her authorized agent and I agree to conform to all applicable laws of the jurisdiction. In addition, if a permit for Work described in this application is issued, I certify that the code official or the code official's authorized representative shall have the authority to enter areas covered by such permit at any reasonable hour to enforce the provisions of the code(s) applicable to such permit.

I HEREBY ACKNOWLEDGE THAT I HAVE READ AND FULLY UNDERSTAND THE ABOVE LISTED INSTRUCTIONS.

SIGNATURE OF APPLICANT: Edwin Glynn DATE: 3/30/16

PRINT NAME: Edwin Glynn

PERMIT # 33958 BATCH # 33958 CHECK # 9745 DATE _____

EXISTING;

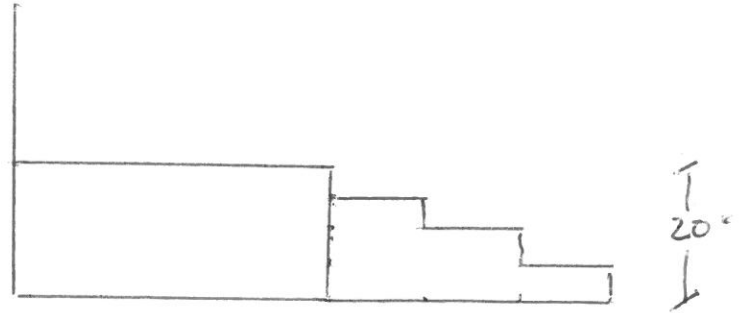
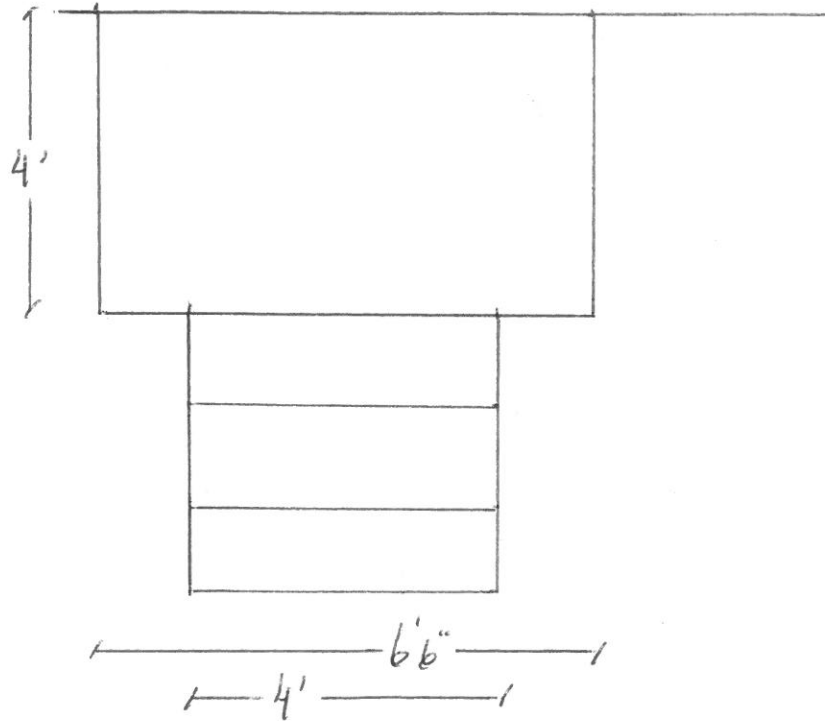

14" DEEP STEPS

20" To
DECK & 24"
To Bottom of
DOOR

CUSTOMER WANT
RAIL ALL AROUND
AND DOWN STAIRS!!

NEW;

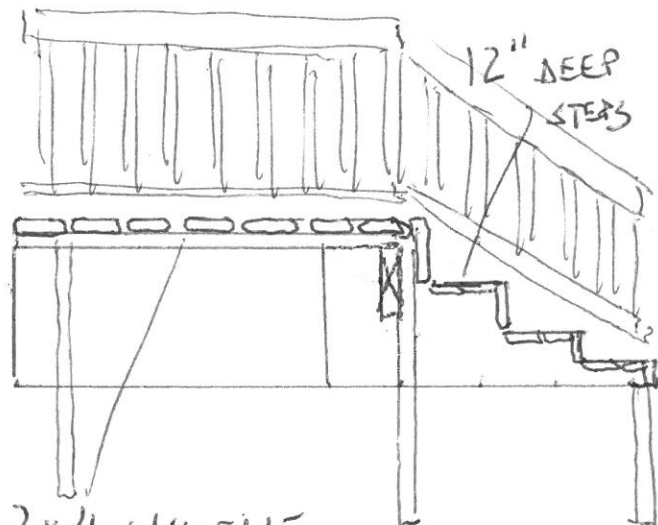
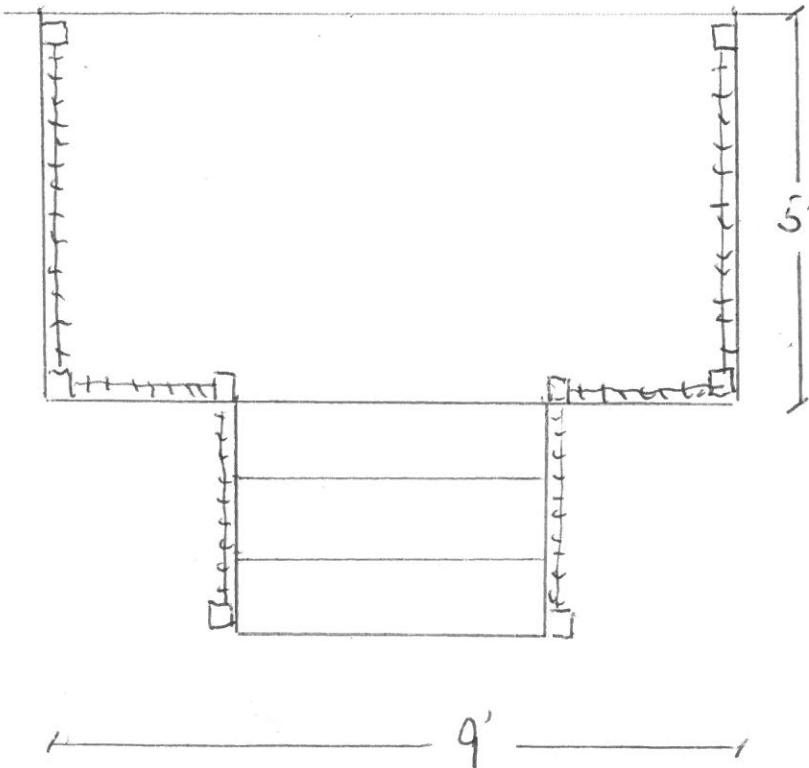

2x4 LAG FLAT
ON EX STOOP

WRAP W/ FRAME BOARD
(TO CONCEAL END BEAM)